



SPA Sandwich Panel Anchor

Installation instructions

PFEIFER

SPA-1 sandwich panel anchor – installation instructions

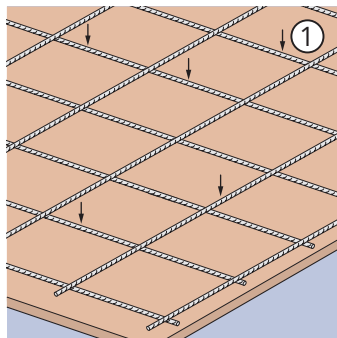

Reinforcing the facing layer

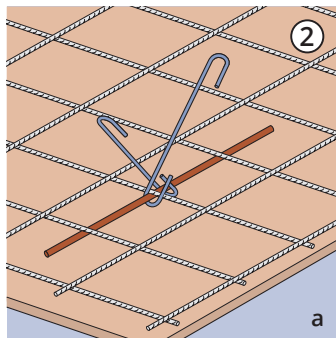

Mounting the SPA bearing anchor

a) Negative process

Position the anchor on the mesh reinforcement. Guide the additional reinforcement (Appendix 6, Table 6) under the mesh reinforcement through the hook ends of the bearing anchors and fix it.

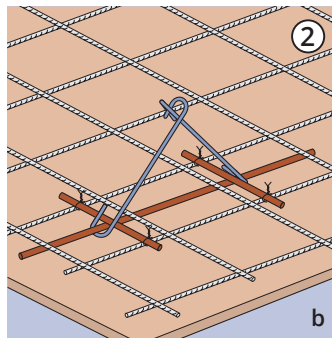

b) Positive process

Use bearing anchors with welded round bars $\varnothing 4 \times 300$ (special item). Position the bearing anchors on the upper reinforcement mesh of the load bearing layer and fix them. Guide the additional reinforcement (Appendix 6, Table 6) under the mesh reinforcement through the hook ends of the bearing anchors and fix it.

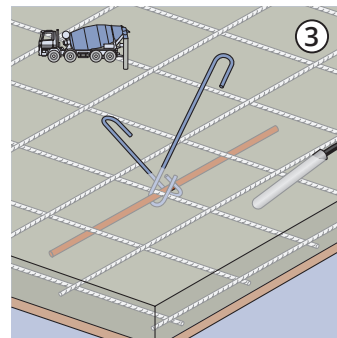

Concrete and compact the facing layer

- Pour the concrete carefully!
- Avoid direct contact between the vibrator and the anchor!
- Do not move the anchor by force or damage it!

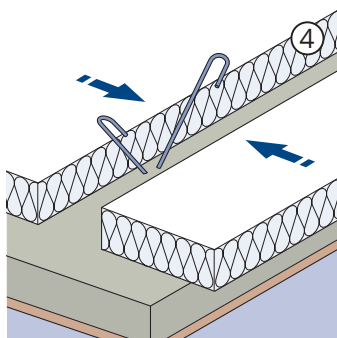

Installing thermal insulation

- Cut the thermal insulation along the SPA bearing anchor. Install the thermal insulating elements with an exact fit.
- Avoid hollow spaces between the thermal insulation and the anchor!
- Fill local hollow spaces with a suitable thermally insulating foam.
- Observe the embedment depth of the SPA bearing anchor according to Appendix 5, Table 4!

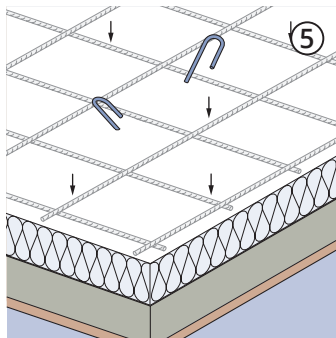

Reinforce the load bearing layer

Install and position the surface reinforcement.

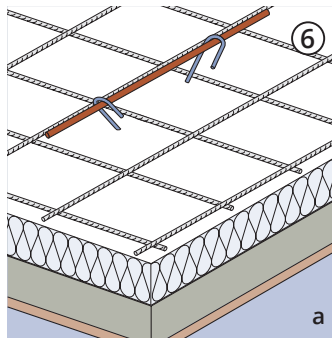

Install the additional reinforcement

a) Negative process

Guide the additional reinforcement (Appendix 6, Table 6) over the mesh reinforcement through the hook ends of the bearing anchors and fix it.

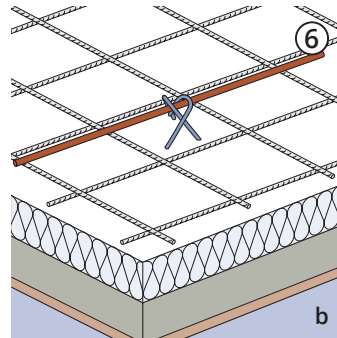

b) Positive process

Guide the additional reinforcement (Appendix 6, Table 6) over the mesh reinforcement through the hook ends of the bearing anchors and fix it.

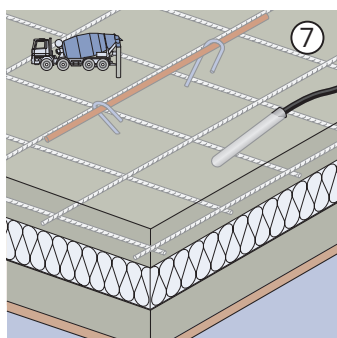

Concrete and compact the load bearing layer

- Pour the concrete carefully!
- Avoid direct contact between the vibrator and the anchor!
- Do not move the anchor by force or damage it!

SPA-2 sandwich panel anchor – installation instructions

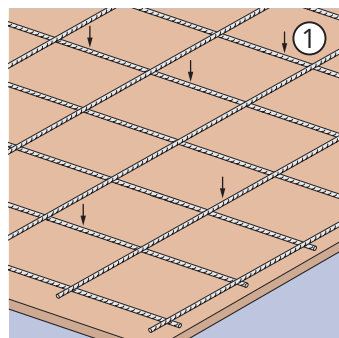

Reinforcing the facing layer

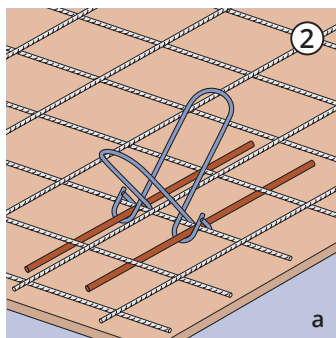

Mounting the SPA bearing anchor

a) Negative process

Position the anchor on the mesh reinforcement. Guide the additional reinforcement (Appendix 6, Table 6) under the mesh reinforcement through the hook ends of the bearing anchors and fix it.

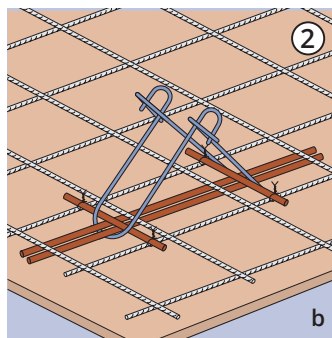

b) Positive process

Use bearing anchors with welded round bars $\varnothing 4 \times 300$ (special item). Position the bearing anchors on the upper reinforcement mesh of the load bearing layer and fix them. Guide the additional reinforcement (Appendix 6, Table 6) under the mesh reinforcement through the hook ends of the bearing anchors and fix it.

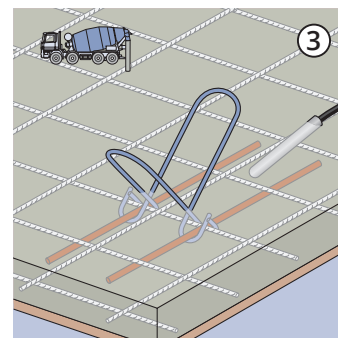

Concrete and compact the facing layer

- Pour the concrete carefully! Avoid direct contact between the vibrator and the anchor!
- Do not move the anchor by force or damage it!

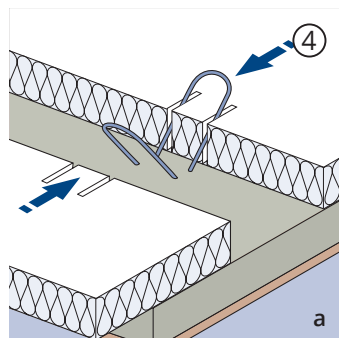

Installing thermal insulation

- Cut the thermal insulation to size according to the anchor dimensions.
- Install the thermal insulating elements with an exact fit.
- Avoid hollow spaces between the thermal insulation and the anchor!

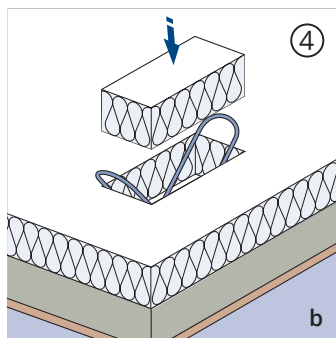

- Fill local hollow spaces with a suitable thermally insulating foam.
- Observe the embedment depth of the SPA bearing anchor according to Appendix 5, Table 4!

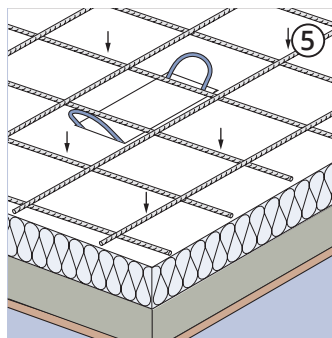

Reinforce the load bearing layer

- Install and position the surface reinforcement.

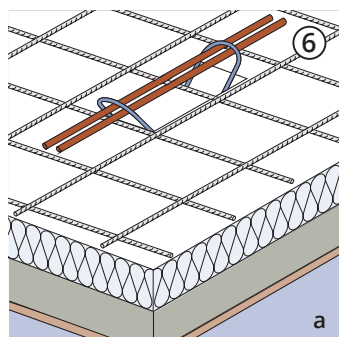

Install the additional reinforcement

a) Negative process

Guide the additional reinforcement (Appendix 6, Table 6) over the mesh reinforcement through the hook ends of the bearing anchors and fix it.

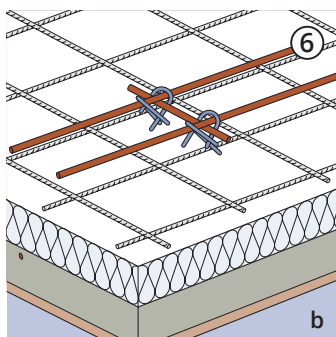

b) Positive process

Guide the additional reinforcement (Appendix 6, Table 6) above the mesh reinforcement longitudinally and transversely through the hook ends of the bearing anchors and fix it. Observe additional transverse bar $1 \times \varnothing 8 \text{ mm}$, $l = 300 \text{ mm}$ in the facing layer!

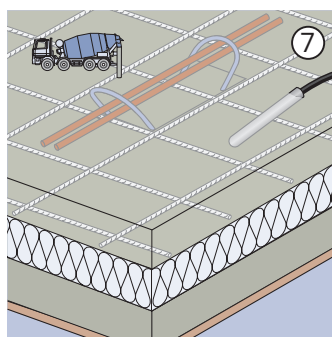

Concrete and compact the load bearing layer

- Pour the concrete carefully!
- Avoid direct contact between the vibrator and the anchor!
- Do not move the anchor by force or damage it!

DEUTSCHLAND

**Pfeifer Seil- und
Hebetechnik GmbH**

87700 Memmingen
Dr.-Karl-Lenz-Straße 66

Tel.: +49 8331 937 345

E-Mail: bautechnik@pfeifer.de

Internet: www.pfeifer.info/bautechnik

PFEIFER

03.20